

MULTIPURPOSE LUMINAIRE

TL VARIO

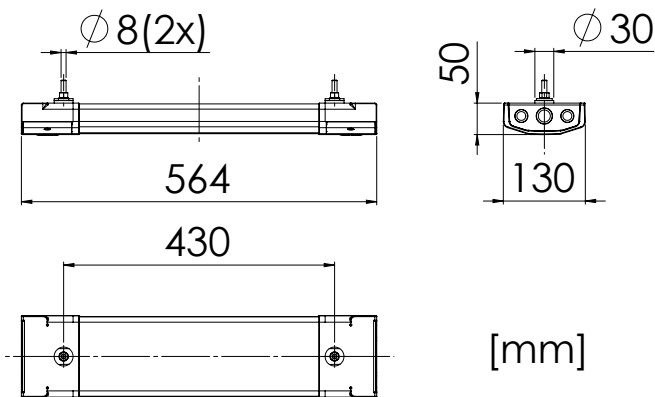









MULTIPURPOSE WATERTIGHT LUMINAIRE FOR MACHINERY SPACES, WORKSHOPS, STORES, CORRIDORS, OPEN DECKS AND HANGAR



STANDARD CONFIGURATION

Housing/Cover	Opal polycarbonate, impact-proof, UV resistant
Mounting	M8 bolts
Cable entry	Max. 4 cable glands
Protection class	IP66/67
Light source	Linear LP LED modules
Wattage	Max. 20W
Luminous flux	2,200 lm
CCT (color)	4,000 K
CRI	≥ 80

AVAILABLE FEATURES

	EMI proof
	Shock proof
	Vibration resistant
	NVG compatible
	Adaptation light
	Multi-circuit
	Various optics
	Controllable

YOUR REQUIREMENTS

Please contact us for different configurations or further information on this luminaire type. Based on your requirements, the final part number will be provided.

Technical modification reserved without prior notice.



LIGHTPARTNER LICHTSYSTEME GMBH & CO. KG
AM MOHRENSHOF 7 · 28277 BREMEN · GERMANY
+49 (0)421 - 87 195 - 0 · SALES@LIGHTPARTNER.DE

LIGHTPARTNER NAVY