

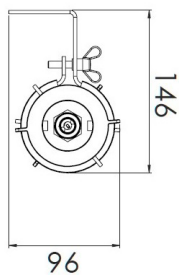

PRESSURE WATERTIGHT LUMINAIRE FOR OPEN DECKS AND DECK RAILS

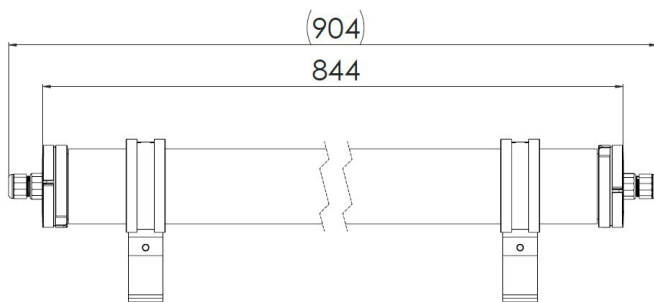

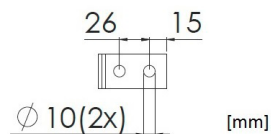





fixing clamp (not included)



### STANDARD CONFIGURATION

Housing/Cover	Clear polycarbonate, impact-proof, UV resistant
Mounting	2 stainless steel fixing clamps
Cable entry	Max. 2 cable glands
Protection class	IP68
Light source	Linear LP LED module
Wattage	Max. 9W
Luminous flux	1,200 lm
CCT (color)	4,000 K
CRI	≥ 80

### AVAILABLE FEATURES

	EMI proof
	Shock proof
	Vibration resistant
	NVG compatible
	Adaptation light
	Multi-circuit

### YOUR REQUIREMENTS

Please contact us for different configurations or further information on this luminaire type. Based on your requirements, the final part number will be provided.

Technical modification reserved without prior notice.



LIGHTPARTNER LICHTSYSTEME GMBH & CO. KG  
AM MOHRENSHOF 7 · 28277 BREMEN · GERMANY  
+49 (0)421 - 87 195 - 0 · SALES@LIGHTPARTNER.DE

**LIGHTPARTNER NAVY**